

DUNHAM HALL

MASS COMMUNICATIONS,
THEATRE & DANCE CHAIR, &
TICKET BOX OFFICE

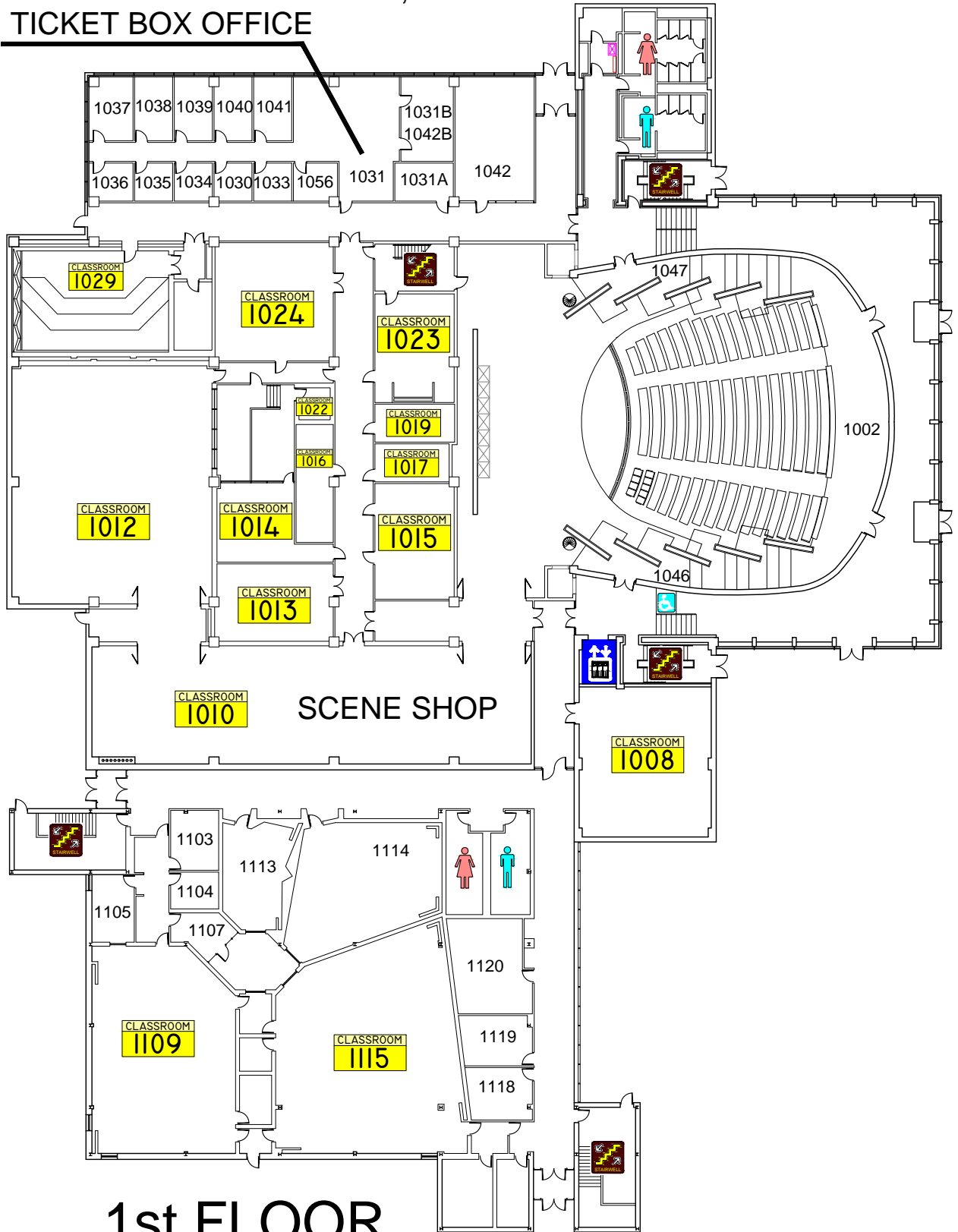

1st FLOOR

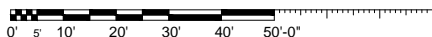

DUNHAM HALL

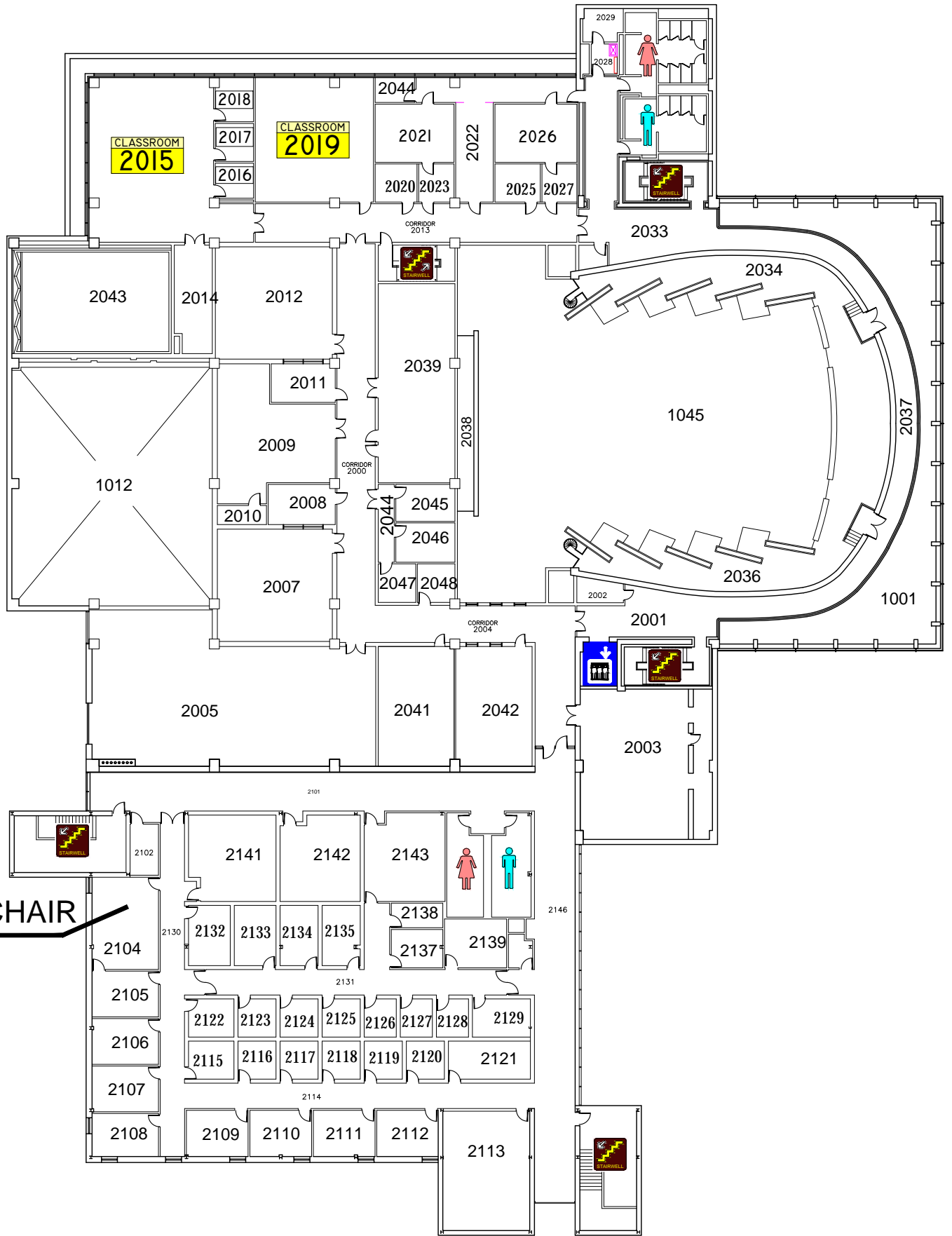

MUSIC CHAIR

2nd FLOOR

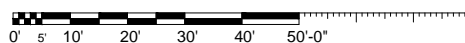

EMERGENCY STORM SHELTERS

In event of a Tornado Warning everyone should go to a

PRIMARY STORM SHELTERS

located here on the lower level

DUNHAM HALL

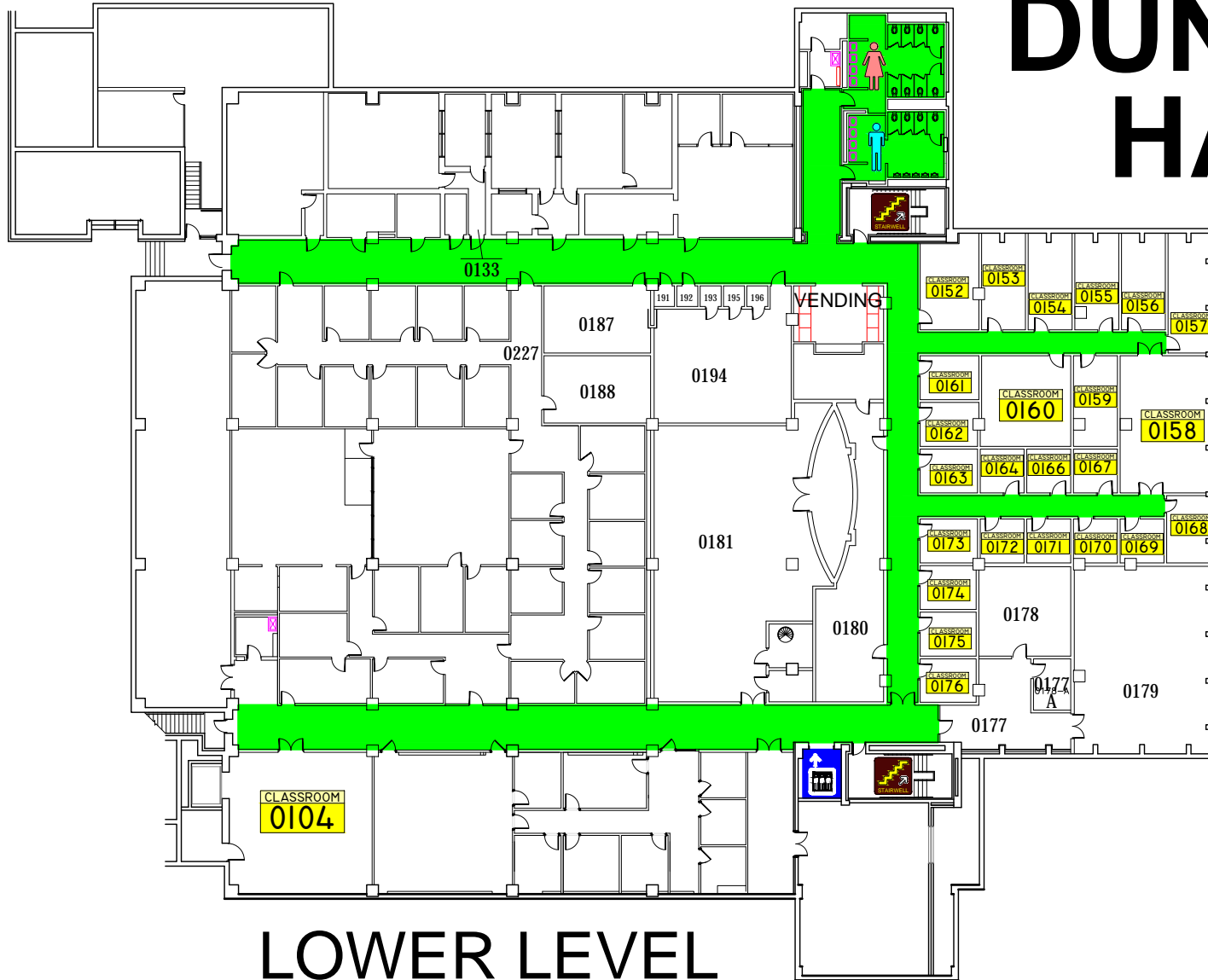

LOWER LEVEL

0' 5' 10' 20' 30' 40' 50'-0"

EMERGENCY STORM SHELTERS

In event of a Tornado Warning everyone should go to a Lower Level **Primary Storm Shelter**

In event you can not get to a Primary Shelter go to a **Secondary Storm Shelter**

located on 1st, 2nd, & 3rd floors

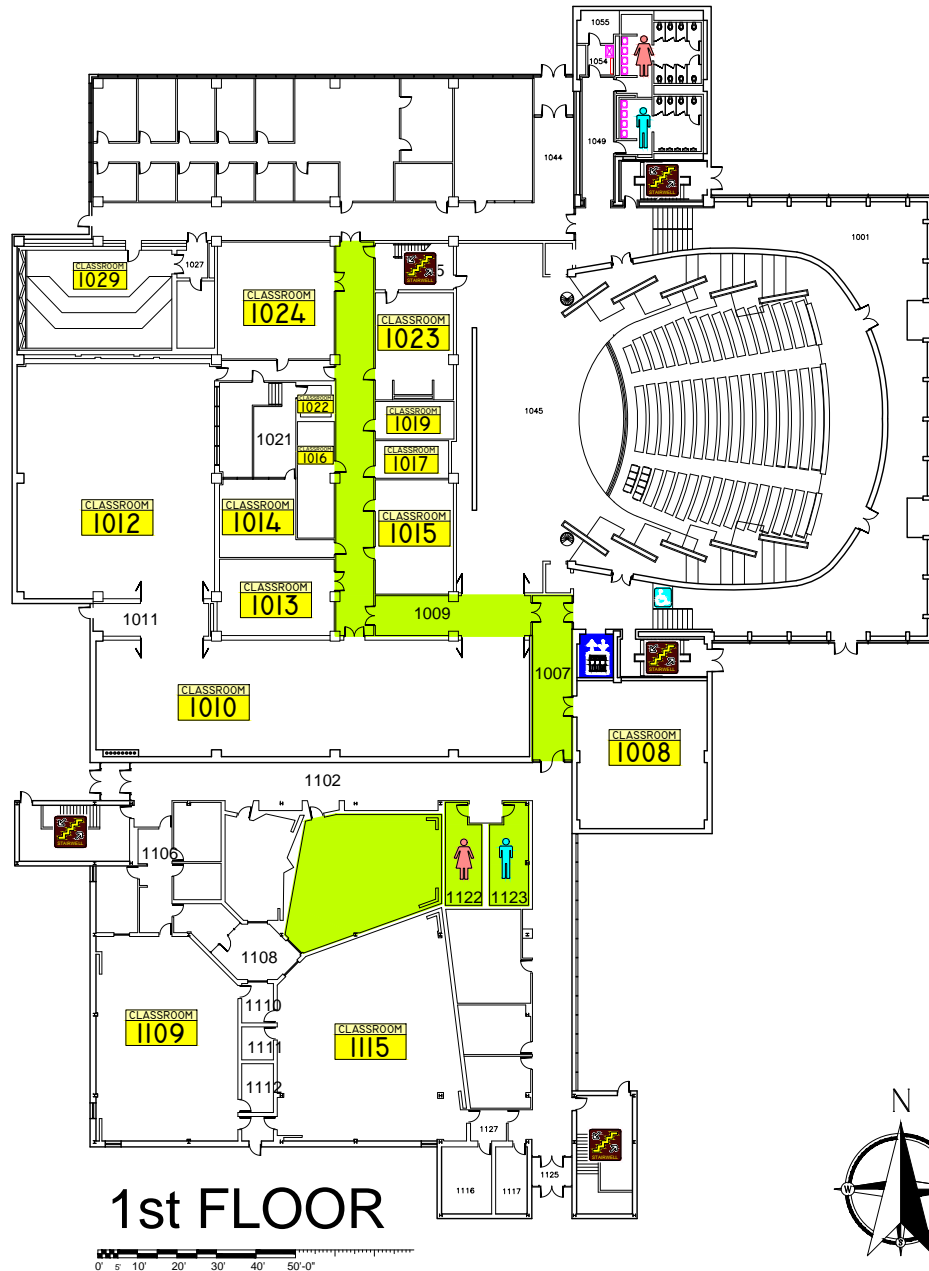

DUNHAM HALL

EMERGENCY STORM SHELTERS

In event of a Tornado Warning everyone should go to a Lower Level **Primary Storm Shelter**

In event you can not get to a Primary Shelter go to a **Secondary Storm Shelter**

located on 1st, 2nd, & 3rd floors

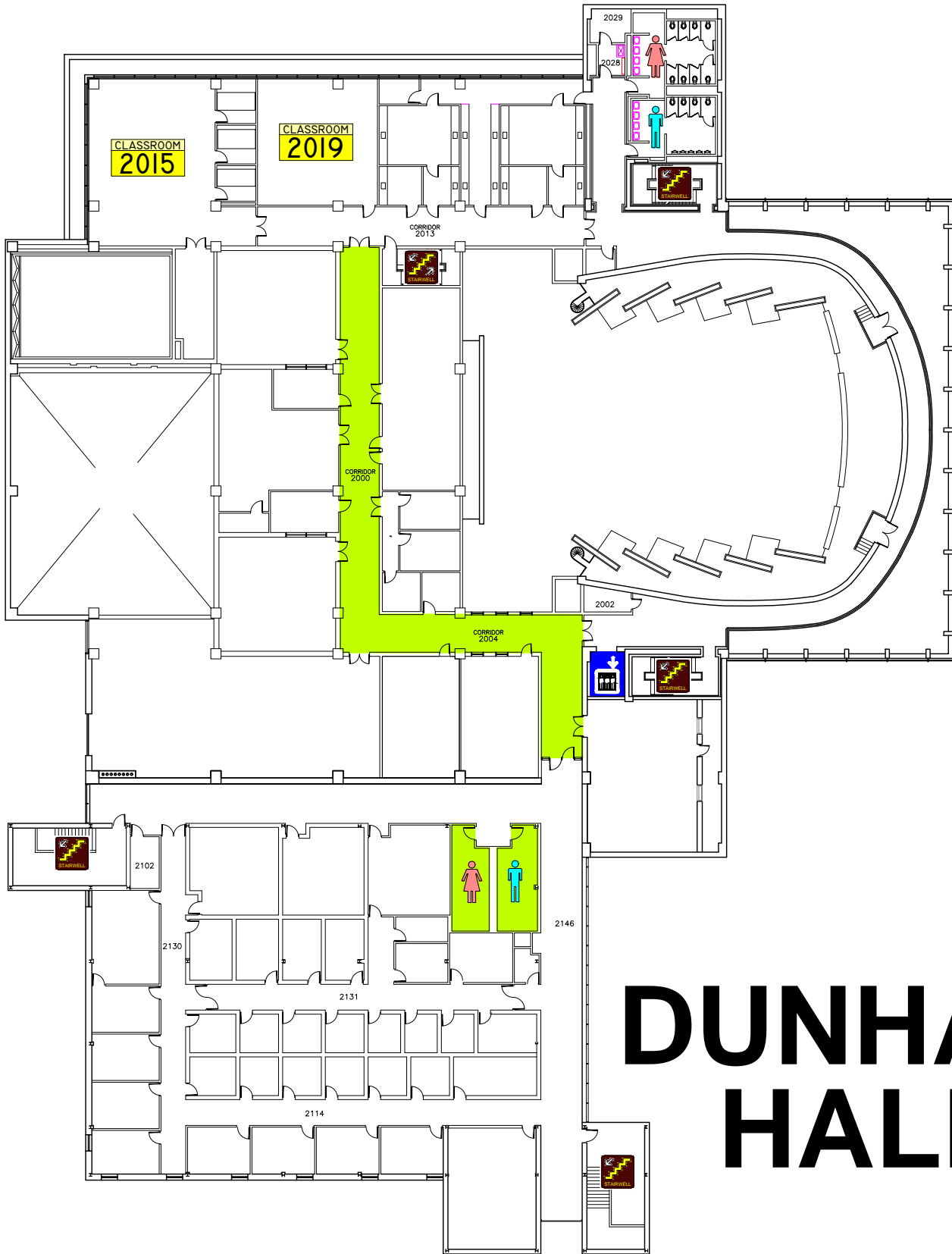

DUNHAM HALL

2nd FLOOR

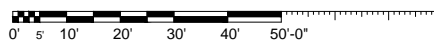

EMERGENCY EXIT PLAN

EXIT IN CASE OF EMERGENCY USE MARKED EXITS **EXIT**

 DO NOT USE ELEVATORS 

 WHEELCHAIR USERS ARE TO GO INTO 
STAIR WELLS **EXIT** AND WAIT FOR EMERGENCY PERSONNEL.

DUNHAM HALL 2nd FLOOR

