

Faunal Analysis of the 2005 Stephenson House Excavations in Madison County, Illinois: The Analysis of Socioeconomic Status in the Upland South Cultural Tradition

Lacey N. Heflin

The Stephenson House



Introduction

■ Location



Objectives and Importance

- Analysis of animal remains
- Reconstruct socioeconomic status
– Upland South
- National Register of Historic Places

Historical Background

- The Benjamin Stephenson occupation
- The Frederick Wolf occupation



Probate Records

- Pig
- Beef



Zooarchaeology and the Upland South Cultural Tradition

- Importance of faunal analysis
- Applications of data
- Socioeconomic status

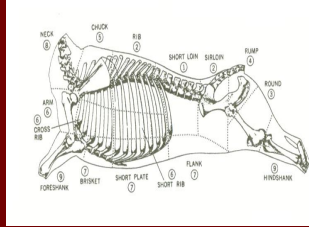

Research Design and Excavation Methods

- Field procedures and results
- Laboratory methods



2005 Stephenson House Excavations

Colonel Benjamin Stephenson House
Office/Dump Excavations: Summer 2005

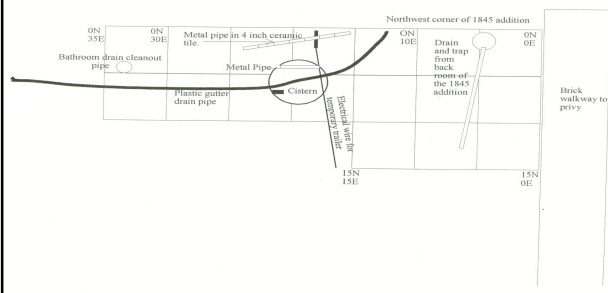

Laboratory Methods

- Comparative Collection
- NISP
- MNI

Analytical Methods

- Butchery
- Pork and Beef (*Sus scrofa* and *Bos taurus*)
- Correlation rankings

Exploitation of Animal Resources

- Overview
- Aquatic Animals (12%)
- Wild Mammals (<1%)
- Domestic Pig (47.6%)
- Domestic Chicken (21%)
- Domestic Cow (10%)
- Domestic Sheep/Goat (< 4%)

Calculations of Animal Exploitation

- Cultural Modifications
- Butchery and Economic Relationships
 - *Sus scrofa*: -0.33 correlation ($p = .298$)
 - *Bos taurus*: -0.62 correlation ($p = .025$)

Scatter Plot of Economic Ranking Among Identified *Sus scrofa* Butchery

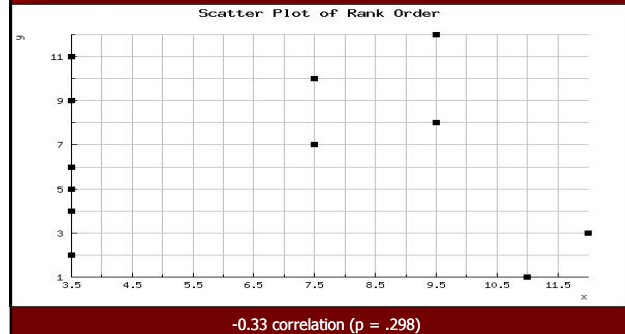

Scatter Plot of Economic Ranking Among Identified *Bos taurus* Butchery

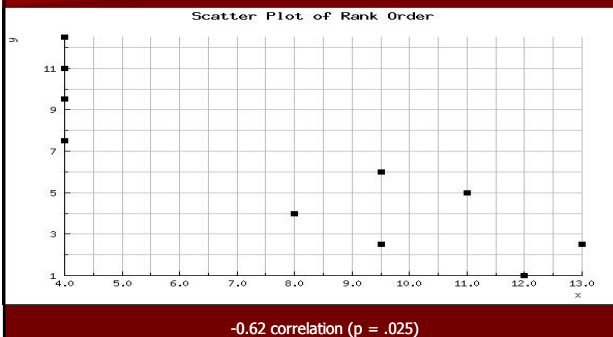

Discussion and Conclusions

- Results
- Potential for further research

Acknowledgments

- Dr. Julie Holt
- Dr. Terrance Martin
- Dr. Sid Denny
- Ms. Michele Lorenzini

QUESTIONS?